

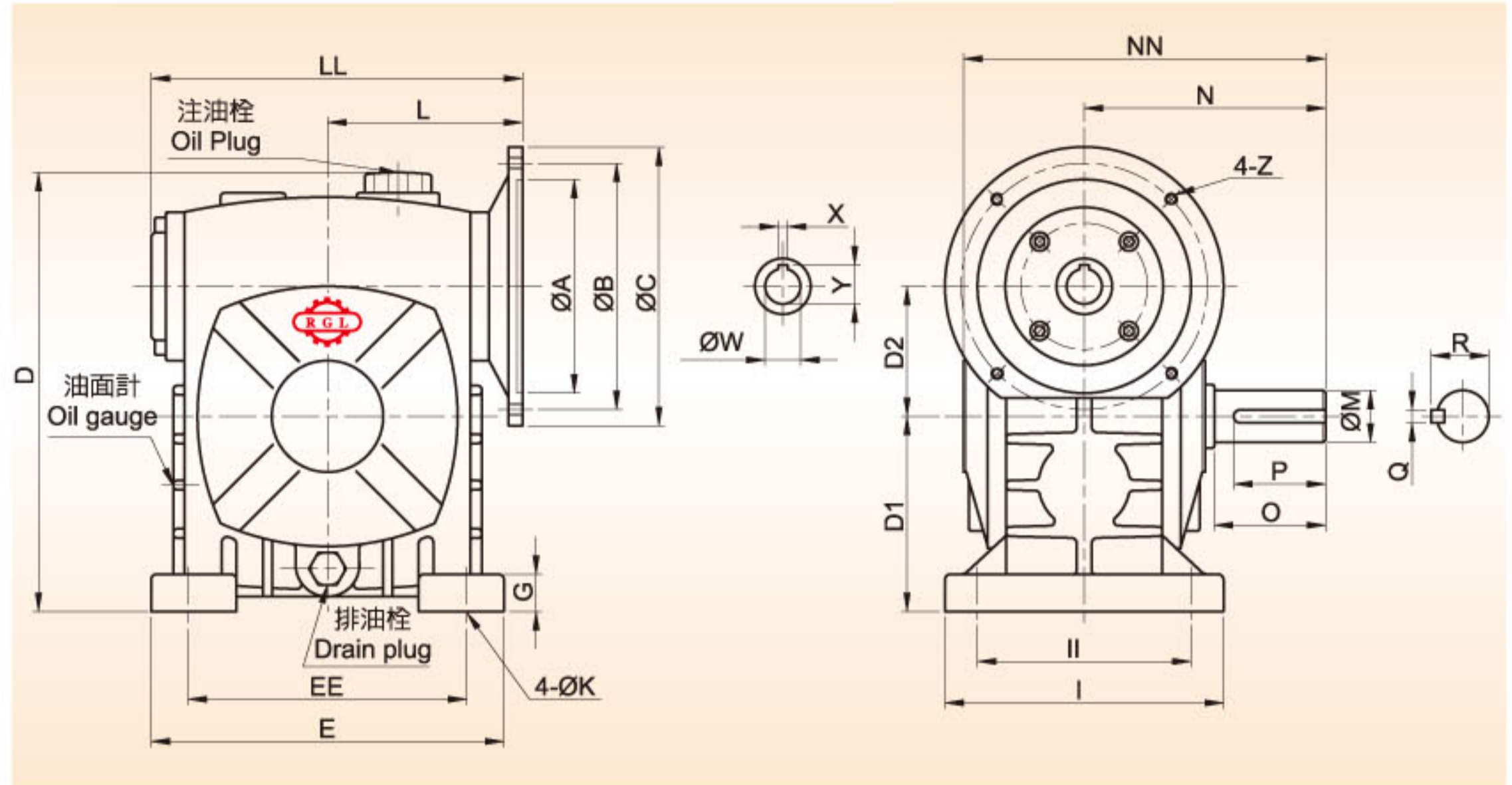

◀ Type: WE ▶



● 尺寸表 Dimensions ●

| 型號<br>SIZE | LL  | L   | NN  | N   | D1  | D2  | D   | EE  | E   | II  | I   | G  | K  |
|------------|-----|-----|-----|-----|-----|-----|-----|-----|-----|-----|-----|----|----|
| 50         | 154 | 84  | 145 | 95  | 80  | 50  | 180 | 110 | 140 | 95  | 120 | 15 | 11 |
| 60         | 160 | 85  | 165 | 110 | 90  | 60  | 202 | 120 | 150 | 105 | 130 | 20 | 11 |
| 70         | 196 | 102 | 195 | 130 | 105 | 70  | 236 | 150 | 190 | 115 | 150 | 20 | 15 |
| 80         | 217 | 113 | 210 | 140 | 120 | 80  | 265 | 180 | 220 | 135 | 170 | 20 | 15 |
| 100        | 280 | 148 | 260 | 170 | 150 | 100 | 352 | 220 | 270 | 155 | 190 | 25 | 15 |
| 120        | 318 | 165 | 290 | 190 | 180 | 120 | 424 | 260 | 320 | 180 | 230 | 30 | 18 |
| 135        | 367 | 188 | 320 | 210 | 215 | 135 | 481 | 290 | 350 | 200 | 250 | 30 | 18 |
| 155        | 395 | 203 | 387 | 252 | 235 | 155 | 510 | 320 | 380 | 220 | 280 | 36 | 20 |
| 175        | 440 | 223 | 407 | 262 | 260 | 175 | 577 | 350 | 410 | 250 | 310 | 37 | 20 |

| 型號<br>SIZE | 馬力 HP         |               | 馬達盤 MOTOR FLANGE |            |            |            | 入力孔 INPUT BORE |          |            | 出力軸 OUTPUT SHAFT |     |    |    |      | 重量 (Kg) |
|------------|---------------|---------------|------------------|------------|------------|------------|----------------|----------|------------|------------------|-----|----|----|------|---------|
|            | 1/10~<br>1/30 | 1/40~<br>1/60 | A                | B          | C          | Z          | W              | X        | Y          | O                | P   | M  | Q  | R    |         |
| 50         | 1/4           | 1/8           | 110              | 130        | 160        | M8         | 11             | 4        | 12.5       | 40               | 35  | 17 | 5  | 19   | 8       |
| 60         | 1/2           | 1/4           | 110              | 130        | 160        | M8         | 11<br>14       | 4<br>5   | 12.5<br>16 | 50               | 45  | 22 | 7  | 25   | 10      |
| 70         | 1             | 1/2           | 110<br>130       | 130<br>165 | 160<br>200 | M8<br>M10  | 14<br>19       | 5<br>6   | 16<br>21.5 | 60               | 55  | 28 | 7  | 31   | 15      |
| 80         | 2             | 1             | 130              | 165        | 200        | M10        | 19<br>24       | 6<br>8   | 21.5<br>27 | 65               | 60  | 32 | 10 | 35.5 | 21      |
| 100        | 3             | 2             | 130<br>180       | 165<br>215 | 200<br>250 | M10<br>M12 | 24<br>28       | 8        | 27<br>31   | 75               | 70  | 38 | 10 | 41.5 | 40      |
| 120        | 5             | 3             | 180              | 215        | 250        | M12        | 28             | 8        | 31         | 85               | 80  | 45 | 12 | 48.5 | 61      |
| 135        | 7-1/2         | 5             | 180<br>230       | 215<br>265 | 250<br>300 | M12        | 28<br>38       | 8<br>10  | 31<br>41   | 95               | 90  | 55 | 15 | 60   | 93      |
| 155        | 10            | 7-1/2         | 230              | 265        | 300        | M12        | 38             | 10       | 41         | 110              | 105 | 60 | 15 | 65   | 108     |
| 175        | 15            | 10            | 230<br>250       | 265<br>300 | 300<br>350 | M12<br>M16 | 38<br>42       | 10<br>12 | 41<br>45   | 110              | 105 | 65 | 18 | 71   | 165     |

● 軸配置及旋轉方向 Shaft Arrangement and Rotation Direction ●

